

*Parents Music Club
presents the*



*Portsmouth
Public Schools
Performing Arts
Concert Series
2018-19*

Sponsored By

Tate & Foss | **Sotheby's**
INTERNATIONAL REALTY

Proud supporters of education, arts and culture throughout the Seacoast.

Tate & Foss

Sotheby's

INTERNATIONAL REALTY



29 BRIGHAM LANE | PORTSMOUTH NH

Portsmouth Harbor and City Skyline Views

5,489 SF, 4 BR | \$1,049,000 | **SHARON PARKER + TONY JALBERT**



133 ISLINGTON STREET, UNIT 7 | PORTSMOUTH NH

Captain Andrew Hussey House (c.1804)

1,584 SF, 2 BR | \$649,000 | **TONY JALBERT**



649 STATE STREET | PORTSMOUTH NH

Historic Apartment Building in Emerging West End of Portsmouth

3,393 SF, 4 BR | \$1,099,000 | **TONY JALBERT**



90 OCEAN BOULEVARD | NORTH HAMPTON NH

1900's Gambrel-Style Home with 180-Degree Views of the Ocean

4,020 SF, 7 BR | \$1,800,000 | **SHARON PARKER**



282 ROCKLAND STREET | PORTSMOUTH NH

Victorian Envy Overlooking City Hillside

2,937 SF, 5 BR | \$840,000 | **CAROL PARKER**



274 WASHINGTON ROAD | RYE NH

Expanded Antique Cape on 1.7 Acres

3,000 SF, 3 BR | \$799,000 | **LYNNE JOYCE**



100 LOCKE ROAD | RYE NH

Ranch-Style Home Steps to Rye Harbor and Top-Notch Beaches

1,440 SF, 3 BR | \$699,000 | **MARY BETH HIXON**

Live the
Seacoast Lifestyle.

Tate & Foss

Sotheby's

INTERNATIONAL REALTY

566 WASHINGTON ROAD, RYE NH

603.964.8028 | LIVESEACOAST.COM

PORTSMOUTH SYMPHONY ORCHESTRA



listen live. listen local.



portsmouth
symphony orchestra

JOHN PAGE, MUSIC DIRECTOR

The
MUSIC HALL
28 CHESTNUT STREET
PORTSMOUTH, NH

portsmouthsymphony.org



PPMtv

Portsmouth Public Media

Come grow with us!
Produce, design, write,
edit, or crew your own
or someone else's show.
Don't know how? No
problem. We'll teach you!

**Everyone
has a story.**

Founded in 2010 as a 501c3 education and arts non-profit, **Portsmouth Public Media, Inc.** (PPMtv) is a **member-run** community television station, serving Portsmouth and the surrounding area. Housed in the historic South End Meeting House, PPMtv honors this building's tradition by providing a 21st Century Meeting House, a place for people to come together, share their viewpoints, meet their neighbors, and tell their stories. PPMtv programming can be found on **Comcast channel 98** in Portsmouth and streaming live at:

ppmtvnh.org

What's yours?

PPMtv is looking for community **sponsors** and **underwriters** to help us grow!

Give us a call if you'd like to join the conversation.

280 Marcy Street, Portsmouth, NH 03801, tel: 603-427-8093, info@ppmtvnh.org

The **Country View**

BREAKFAST • LUNCH • FRIENDS



**Have a great season
Portsmouth Clipper
Performing Arts!!**

**Open Daily!
Mon-Fri 6am-2pm
Sat 6am-1:30pm
Sun 7am-1:30pm**

692 Portsmouth Ave., Greenland, NH (603)431-7426

**15% off your bill
with this coupon.**

Coupon code: MUSIC15



(Valid Mon. - Fri.
Expires 6/30/2016.
Discount does not
apply to alcohol or tax.)



Daniel H. De Tolla, DDS, MD
Seacoast
Dental Implant & Oral Surgery Center



Daniel H. De Tolla, DDS, MD
Seacoast
Dental Implant & Oral Surgery Center



Daniel H. De Tolla, DDS, MD
Seacoast
Dental Implant & Oral Surgery Center

Daniel H. De Tolla, DDS, MD, PA

200 Griffin Road Suite 8
Portsmouth, NH 03801

Telephone

Phone: 603-436-3608

Fax: 603-436-3646

Email

info@seacoastoralsurgery.com



PORTSMOUTH, NH

PLANET FITNESS

775 Lafayette Road
Portsmouth, NH 03801
United States

603-436-5797

CLUB HOURS

Open and Staffed 24 Hours, 7 Days a week

+ Holiday Hours



We proudly support The Parents Music Club and their goal to foster performing arts programs in the Portsmouth Public Schools.



PISCATAQUA
SAVINGS BANK
Portsmouth's Local Bank
Since 1877

FDIC

15 Pleasant Street • Portsmouth, NH 03801
603.436.5250 • 1.800.286.5254 • www.piscataqua.com



COOL BAR. HUGE DECK. GREAT FOOD.

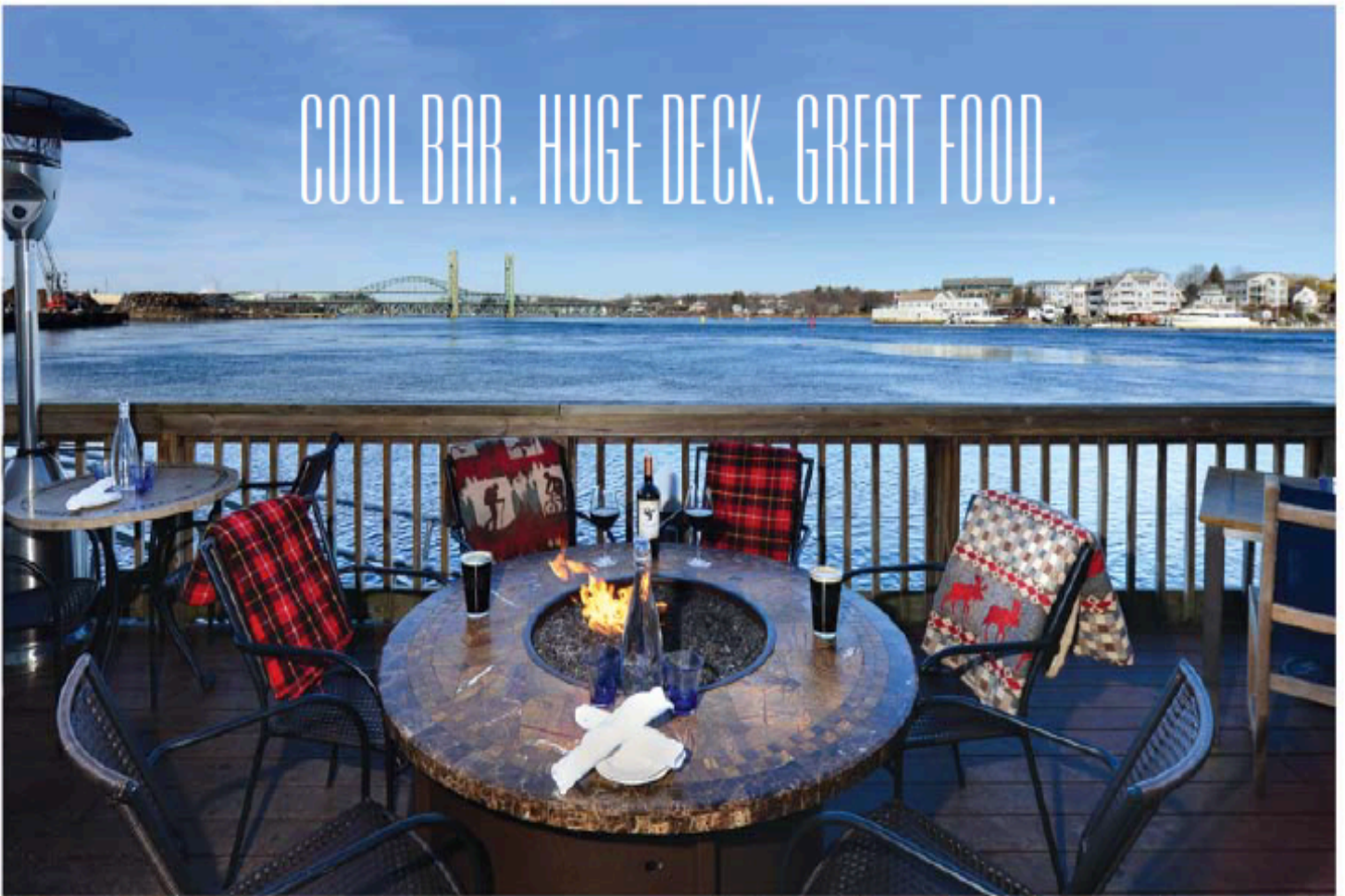

Casual Dining on the Waters Edge

99 Bow Street, Portsmouth, NH
Phone: 603.431.0901
martingalewharf.com

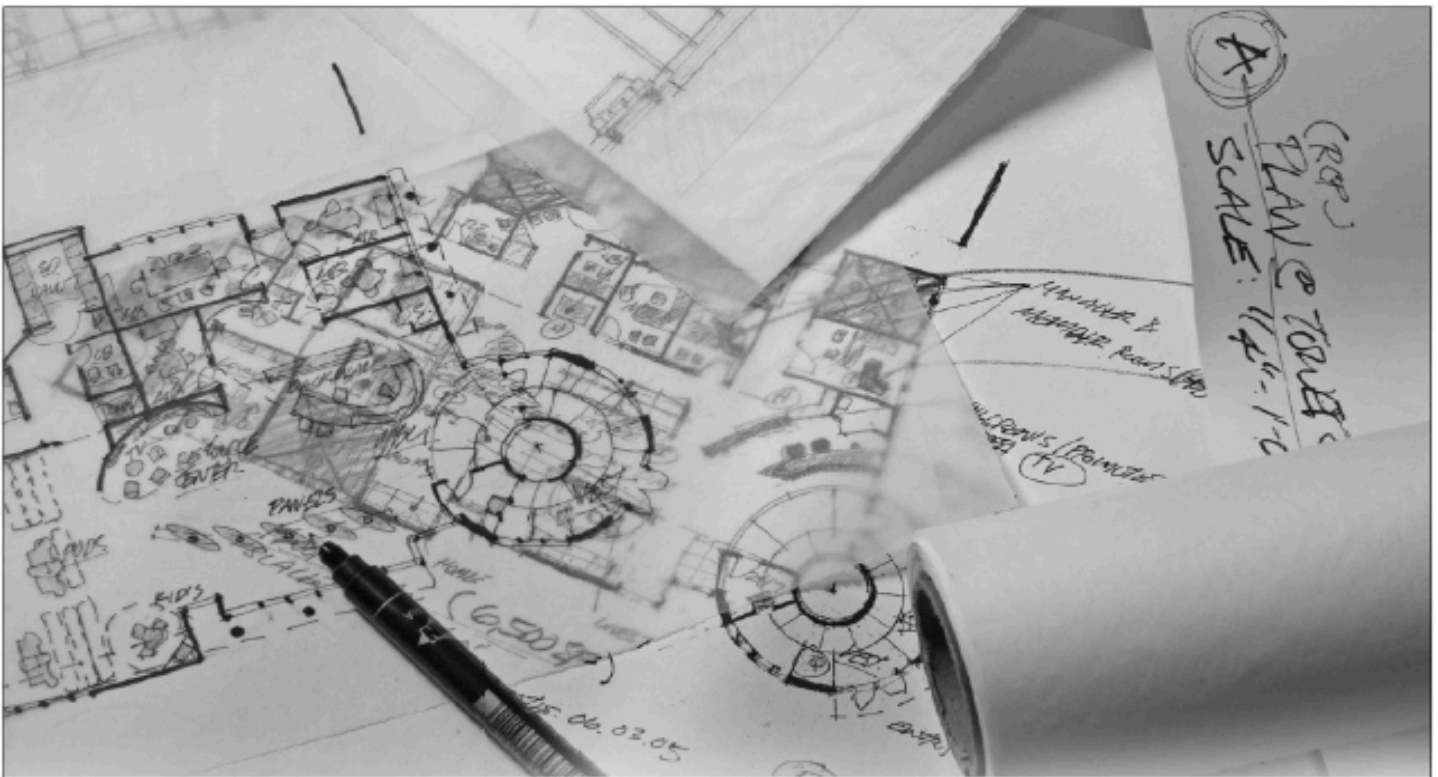

In our world, architectural creativity and integrity are partners.

Creativity and integrity are inseparably linked and reinforced by a commitment to making you a partner in the design process. Thomas A. House, AIA is the founding Principal of THA Architects, LLC and has more than 25 years of professional experience in the areas of design, planning and construction. Tom contributed to the design of numerous developments including a mixed-use building, an adaptive re-use of existing mill building and skilled nursing residences with an Alzheimer unit component. Tom also has extensive experience in the design of luxury flat and townhouse condominiums, 55+ communities, live/work artist lofts, multi-family apartments, Assisted Living Facilities with a skilled nursing component and Continuing Care Retirement Communities consisting of independent living units, assisted living units, and healthcare rooms.

THA Architects, LLC is currently working on a Continuing Care Retirement Community (200 Independent Living Units, 40 Assisted living Units and 54 healthcare beds), 19,000 sf Medical Office Building, 50,000 sf Commercial strip mall, 5,000 sf restaurant and renovation of a historic building to house luxury condominiums to name a few.

Tom has worked on projects up and down the Eastern seaboard, from Florida, New Jersey, Pennsylvania, and New York and into the New England states of Connecticut, Massachusetts, New Hampshire and Maine. We encourage you to explore the benefits of working with THA Architects, LLC.



THA Architects, LLC

Architecture Planning Consulting Interior Design

THA ARCHITECTS, LLC | 105 WILLOW BROOK AVENUE | STRATHAM NH, 03885
603.770.2491 | WWW.THAARC.COM

2012 EXETER AREA CHAMBER BUSINESS OF THE YEAR



VOYAGER

INSURANCE SERVICES

LISA DAVIS | 603.766.1990



Daniel H. De Tolla, DDS, MD
Seacoast
Dental Implant & Oral Surgery Center



Daniel H. De Tolla, DDS, MD
Seacoast
Dental Implant & Oral Surgery Center



Daniel H. De Tolla, DDS, MD
Seacoast
Dental Implant & Oral Surgery Center

Daniel H. De Tolla, DDS, MD, PA

200 Griffin Road Suite 8
Portsmouth, NH 03801

Telephone

Phone: 603-436-3608
Fax: 603-436-3646

Email

info@seacoastoralsurgery.com

PAY FAIRLY.
EAST COAST
HEATING & AIR CONDITIONING

PO Box 8213, Portsmouth, NH 03802
Phone: 603-430.9414



The
AR&T
Of
Auto Repair



**FOREIGN &
DOMESTIC CARS
WE ARE
GEARED TO
MEET YOUR
AUTOMOTIVE NEEDS**

**N.H. Inspection Station
202 Islington Street
Portsmouth, NH 03801**

436-4594

**REP
ENTERPRISES**



**REP Enterprises
747 Portsmouth Ave. Route 33
Greenland, NH 03840
Phone: 603-431-8445
Mon-Fri 8-5, Sat 9-2, Closed Sunday**

**REP Enterprises (New Location)
4 Smoke Street (off Route 9)
Barrington, NH 03825
Phone: 603-664-5700
Tue-Fri 8-5, Sat 9-2, Closed Sun/Mon**

The advertisement for Mac & Copper's Pet Supply Outlet is set against a background of scattered blue bones and orange paw prints. At the top center is a red doghouse with a blue roof and a sign that says "Mac & Copper's". Two dogs are sitting in front of the doghouse, and a small orange cat is perched on the right side of the main text box. The main text "PET SUPPLY" is in large, bold, blue and red letters, with "OUTLET" in smaller, spaced-out letters below it. The contact information is provided in red and blue text at the bottom.

Mac & Copper's

PET SUPPLY
OUTLET

990 Lafayette Rd. (RTE 1) • Portsmouth, NH 03801
603-427-0055
petsupply.outlet@yahoo.com
WWW.PETSUPPLYOUTLETS.COM
ALL PET SUPPLIES IN Portsmouth and Somersworth

Dr. Geri Hunter



Orthodontist

Creating Beautiful Smiles
For Over 20 Years

603.431.8899

www.seacoastsmiles.com

STEM CELL THERAPY & REGENERATIVE MEDICINE CHANGES THE GAME

Get Back to Enjoying Your Life

- Arthritis/Osteoarthritis
- Hip or Labral tears
- Shoulder damage
- Wrist or Elbow
- Ankle pain/injury
- COPD
- Knee Injuries (CMCL, ACL, PCL, LCL, Sprains and tears)
- Plantar fasciitis
- Peripheral Neuropathy
- ED

If you are not satisfied just masking symptoms with medications, call **603-380-9159** to schedule your consultation or visit www.centerforwell.com.



875 Greenland Rd, Suite B3 Portsmouth, NH 03801 at Orchard Park



Atlantic Karate

TRAINING CENTER



cool salty breezes
entertaining friends
memorable gatherings

D|A
DeStefano | ARCHITECTS
603.431.8701
DestefanoArchitects.com



The Wandering Paddler

PADDLE BOARD TOURS



Paddleboard tours ◦ lessons ◦ rentals
NH lakes ◦ rivers ◦ seacoast

wanderingpaddler.com

603-380-5077

2018-2019 Yearly Schedule

Fall Session 1

September 4th - October 27th
8 weeks
No Classes Columbus Day

Fall Session 2

November 5th - December 22nd
6 weeks
No Classes Veterans Day, and
Nov. 21st-24th

Winter Session 1

January 7th- February 22nd
7 Weeks
No Classes on Martin Luther King Day

Spring Session 1

March 4th - April 19th
7 Weeks

Spring Session 2

April 29th - June 14th
7 Weeks

College Athlete Summer 2019

May 22nd- August 17th
12 Weeks

Summer 2019

June 24th- August 17th
8 Weeks

email: peak@seacoastssportsclubs.com



Peak Performance at
Seacoast Sports
Clubs
West End

Elwyn Park Tree Service and Property Maintenance

Weekly Mowing Schedules

Snow Plowing
Mulch, Loam, Crushed Stone
Delivered and/or Installed
Spring & Fall Cleanups
Free Estimates

Shop (603)433-7172

Cell (603)512-0366

323 McKinley Rd, Portsmouth, NH 03801



NH Monogramming
Embroidery & Screen Printing
www.NHMonogramming.com

30 Palm Drive
P. O. Box 482
Greenland, NH 03840
603.433.5545

Barbara Cots
Owner
NHMonogramming@comcast.net

*With seasonal best wishes to the
entire Clipper Performing Arts family!*



LEADING EDGE 
MOTORSPORT

[Enter Here](#)

Contact Richard Strout: strout@lemd.com, 603-772-1835.

Leading Edge, PO Box 960, Newfields NH 03856

LEADING EDGE 
MARKETING

[Enter Here](#)

Contact Stephanie Seacord: sseacord@lemd.com, 603-772-1835.

Leading Edge, PO Box 960, Newfields NH 03856

Cardinal Point Property Management LLC
520B Portsmouth Avenue
Greenland, NH 03840
(603)570-9112 x.701



CARDINAL POINT

PROPERTY MANAGEMENT

Keith D. Harnum
President
Cell 508-726-4125

Phone 800-225-0998
FAX 978-255-4833

Harnum Industries Ltd.

Rigging & Millwright Service
Transportation • Crane Rental
Custom Concrete • Steel Fabrication

18 Fanaras Drive, Salisbury, MA 01952
www.TheRigger.com • keith@therigger.com

You don't
have to be
Scottish to
wear a kilt.

Kilts / Kilt Rentals
Apparel / Jewelry

Celtic Crossing

112 Congress Street
Portsmouth, NH | 603-436-0200

Importing Authentic Goods
from Ireland, Scotland & Wales
Since 1998



Theresa Almeida-Duncan Photography



LOUIS F. CLARIZIO, DDS PA
ORAL SURGERY & DENTAL IMPLANT CENTER

**Proud Supporter of the
PHS Clipper Performing Arts**

One of New England's Most Trusted & Respected

Implant & Oral Surgery Centers

Portsmouth Office
566 Islington St.
Portsmouth, NH 03801
Voice 603.436.8222
Fax 603.433.3299

Somersworth Office
504 High St.
Somersworth, NH 03878
Voice 603.436.8222
Fax 603.749.6963

www.DrClarizio.com

ECOTECH
Pest Control Services LLC



Thomas Pray, B.S., founder and owner of Ecotech Pest Control Services, is a degreed Entomologist with 25 years of field experience, and fifteen years as a successful business owner operator. He will answer your call and your questions, then provide your service personally. Ecotech Pest Control serves the N.H. Seacoast and southern York county, ME, and is fully licensed and insured.



207 451 9451

Blue Water 
**MORTGAGE
CORPORATION**

NMLS 1291, NH License # 8833-MB, MA Broker License # MB1291, ME License # CS05755, CT License # MCL-1291



bull moose

Focusing on the

Arts

in the Seacoast
for over 40 years!

MEMORIES
STUDIO

rye, n.h.

964-6551



angieBLOOM
Holistic Health & Wellness Coach

How will Health Coaching Work For You?

- Goal Setting and Crystal Clear Step by Step Plan
- Proven Methods to Reduce Stress and Anxiety
- Find a balanced diet that works for YOUR unique body type. (Increase Energy and Weight Optimization)
- Achievable Weekly Action Step to Inspire habit change.

www.angiebloom.com

Coastal Floor
Fashions LLC

◆ 15 Sagamore Rd
Rye, New Hampshire

📞 m.me/Coastalfloorfashionsllc

☎ Call (603) 319-4199

#ORIGINALINSPIREDFEARLESS2

ALYSSA DUNCAN
photography
603\373\0098

Dot's Flower Shop
Established 1871
Fred & Fran Horvath - Owners
603-772-2121
dotsflowershop@yahoo.com DotsFlowerShop.com
152 Front St. Exeter, NH 03833
"Sure smells good in here!"

G. Willikers!
BOOKS & TOYS

Family Fun, Family Run Since 1978!

Madden
group

Jennifer Madden
Managing Broker
371 Sagamore Rd. Rye, NH 03870
Phone || 603.247.2900
Email || jenn@maddenre.com

RE/MAX
RISING TIDE

Beth Simpson
beth@rollinggreennursery.com

T 603.436.2732
F 603.436.2309
RollingGreenNursery.com

Rolling Green Nursery

64 Breakfast Hill Road
Greenland, NH 03840

SIGNATURE
ESCROW & TITLE SERVICES, LLC

your local closing & title experts

110 Brewery Lane, Suite 201
Portsmouth, NH 03801
(603) 431-8100
SignatureTitle.com

Whims & Whatnots
BROWSE...SHOP...SMILE :) REPEAT!!

CARDS - SPECIALTY GIFTS - HOME DECOR
(At the corner of Rt. 1 and Breakfast Hill Rd)

611 Breakfast Hill Road, Suite 2
Greenland, NH 03840
WhimsWhatnots@gmail.com
Facebook.com/WhimsandWhatnots

Jodi Klapes
Owner

603-964-0699

abode

home furnishings
775 Lafayette Rd. Suite 12
Portsmouth, NH 03801
P: 603.431.2117
F: 603.431.3717
abodehomefurnishings.com



THE CUP JOINT Barbers

30 Daniel Street
Portsmouth, New Hampshire 03801
Monday - Saturday . . 431-2038



Juanita M. Fonseca, D.D.S., M.S. Orthodontist



603-436-7791

drfonseca@comcast.net

278 Lafayette Road, Building E

Portsmouth, NH 03801

www.MyPortsmouthOrthodontist.com





Historic Theater: 28 Chestnut Street, Portsmouth, NH
Loft: 131 Congress Street, Portsmouth, NH
B2W Box Office: 603.436.2400 • TheMusicHall.org
[f/MusicHall](https://www.facebook.com/MusicHall) [@MusicHall](https://twitter.com/MusicHall) [i/MusicHallNH](https://www.instagram.com/MusicHallNH)

LEGENDARY ACTS IN AN INTIMATE THEATER

Concerts, Comics, Cinema, & Celebrated Authors



Photo credit: David J. Murray/ClearEyePhoto.com

EXPERIENCE IS EVERYTHING

There is nothing like fully experiencing the arts live on stage or on the big screen together with an audience as one. Be transformed with exhilarating and thought-provoking performances that spark conversation and linger long after the curtain closes.

Join The Music Hall family and become a member!
Tax-deductible annual memberships start at just \$50 for the entire household.

Join today at TheMusicHall.org or call 603.436.2400